

Dimension of interface at counter-assembly

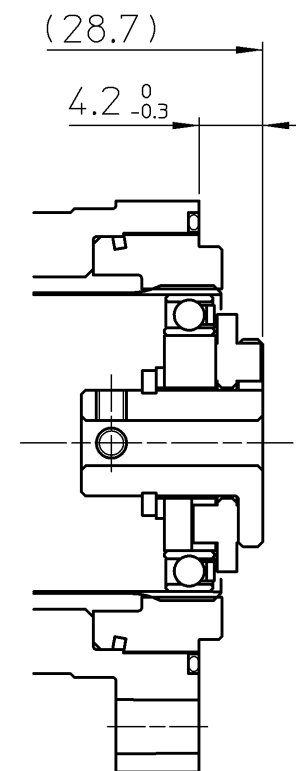

Rating Table

Rated Torque (2000r/min)	Limit for Repeated Peak Torque	Limit for Average Torque	Limit for Momentary Peak Torque	Max. Input Speed	Limit for Average Input Speed
1.8 Nm	3.3 Nm	2.3 Nm	6.6 Nm	8500 r/min	3500 r/min

Performance Date for the Output Bearing

Pitch Circle	Offset	Dynamic Load Rating C	Static Load Rating Co	Permissible Dynamic Tilting Moment	Tilting Moment Stiffness	Permissible Dynamic Axial Load
20.5 mm	7.3 mm	2.16x10 ³ N	1.90x10 ³ N	3.46 Nm	2.76x10 ³ Nm/rad	630 N

REMARKS

Lubrication : Harmonic Drive Harmonic Grease SK-2
 Output Bearing Multemp HL-D

Designing and/or Handling of Harmonic Drive Gears
 (Harmonic Actuators) has to Comply with technical information shown in Harmonic Drive Catalog.

ENCLOSED IN THE BOX	
O-ring	28.20X1.00

CUSTOMER DRAWING NO.	

PROPRIETORSHIP
 This drawing (document) is the PROPERTY of Harmonic Drive Systems, Inc. and shall not be traced, otherwise copied or used for purposes other than agreed upon, nor communicated to any third party without written permission of Harmonic Drive Systems, Inc.

訂正	来歴 DESCRIPTION	設計 DESIGN Y.MIZUTANI Aug-26-10	タイトル TITLE ASSEMBLY DRAWING
仕様 SPEC (標準)		検図 VRFD T.HAGIWARA Aug-26-10	製品名 ARTICLE CSF-8-50-2XH-F
機械加工無記号公差 GENERAL TOLERANCE	備考 REMARKS : 特記無き角はC0.2以下、すみの丸みはR0.4以下	承認 APPD J.KUROGI Aug-26-10	
0 0.5 6 30 120 315 1000	無記号表面アラス 50S 25S 6.3S SURFACES MARKED EXCEPT AS NOTED	DWG SIZE UNIT THIRD ANG A3 mm 第三角	図番 DWG No C2A2181 -
±0.05 ±0.1 ±0.2 ±0.3 ±0.5 ±0.8 ±1.2		HARMONIC DRIVE SYSTEMS INC TOKYO JAPAN	
本図は(株)ハーモニック・ドライブ・システムズの所有に係わるものです。許可なく第三者に見せたり、トレースその他の複写及び指定された用途以外には使用しないで下さい。			